



Power Apps

Sample manual - first two chapters



Wise Owl
Training

TABLE OF CONTENTS (1 of 6)

1	POWER APPS OVERVIEW	Page
1.1	Types of App	8
	<i>Examples of Apps</i>	8
1.2	What you Need	9
	<i>To Design your Apps</i>	9
	<i>To Run your Apps</i>	9
1.3	Getting Help	10
	<i>The Microsoft Website</i>	10
	<i>Opening Template Apps</i>	10

2	CREATING	Page
2.1	Our Simple Starter App	11
2.2	Working with Apps	12
	<i>Creating Apps</i>	12
	<i>Saving your Apps</i>	13
	<i>Opening Apps</i>	14
	<i>Closing Apps</i>	14
2.3	App Settings	15
	<i>Changing the Name and Icon</i>	15
	<i>Setting Screen Size (Tablet Apps Only)</i>	15
	<i>Changing and Locking Orientation</i>	16
2.4	The Power Apps Screen	17
	<i>Adding (and Moving) Screens</i>	18
	<i>Moving Screens</i>	18

3	CONTROLS	Page
3.1	Introduction to Controls	19
	<i>Adding Controls</i>	19
	<i>Changing a Control's Name</i>	20
	<i>Changing Control Properties</i>	20
	<i>Method 1 – Double-Clicking</i>	21
	<i>Method 2 - Using the Menu</i>	21
	<i>Method 3 - Using the Properties Window</i>	21
	<i>Method 4 – Using the Formula Bar</i>	22
	<i>Searching for Properties</i>	22
3.2	Selecting and Grouping Controls	23
	<i>Selecting Controls in the Tree</i>	23
	<i>Selecting Multiple Controls</i>	23
	<i>Grouping and Ungrouping Controls</i>	24
	<i>Using Groups to Make Selection Easier</i>	24
3.3	Working with Controls	25
	<i>Multi-line Textboxes</i>	25
	<i>Padding</i>	25
	<i>Overflow Property for Scrolling Labels</i>	26
	<i>Formatting Controls by Context (Disabled, Pressed and Hover)</i>	26
	<i>Focus Properties</i>	27
	<i>Tooltips</i>	27
	<i>Hint Text (Placeholders)</i>	28
	<i>Displaying a Clear Button</i>	28
3.4	Dealing with Control Errors	29

4	FINISHING	Page
4.1	Completing your App	30
4.2	Navigating between Screens using Buttons	31
4.3	Setting the Start Screen (Correctly)	32
	<i>The OnStart Action – a Legacy Note</i>	32
4.4	Testing your App	33
	<i>Providing an Exit Button</i>	33
	<i>Running an App</i>	33
	<i>The Useful ALT Key</i>	33
4.5	Publishing and Sharing Apps	34

TABLE OF CONTENTS (2 of 6)

5	THEMES AND COLOURS	Page
5.1	Applying a Theme	35
5.2	Colours	36
	<i>Setting the Colour using the Standard Palette</i>	36
	<i>Setting the Colour using the Custom Palette</i>	36
	<i>Setting Colours using the Formula Bar</i>	37
	<i>Setting Colours to other Control's Colours</i>	37
5.3	Lightening or Darkening Colours	38
5.4	Creating Unofficial Themes	39
	<i>Step 1 – Adding a Hidden Page</i>	39
	<i>Step 2 – Adding our Ideal Controls</i>	40
	<i>Step 3 – Create Template Controls</i>	40
	<i>Stage 4 – Use Templates to Format Other Controls</i>	40

6	BASIC DATA APPS	Page
6.1	Our Example	41
6.2	Excel Tables	42
	<i>The Definition of a Table</i>	42
	<i>Creating a Table</i>	42
	<i>Renaming your Table</i>	43
	<i>Removing Fancy Formatting</i>	43
	<i>Listing Tables in a Workbook</i>	44
6.3	Creating Data Sources in your App	45
6.4	Creating Data Tables	46

7	ANATOMY OF AN APP	Page
7.1	Creating a Template Data App	47
7.2	Understanding Generated Data Apps	48
	<i>How this Works – Browse Screen (Gallery)</i>	48
	<i>How this Works – Details Screen</i>	49
	<i>How this Works – Edit Screen</i>	49

8	GALLERIES	Page
8.1	Creating using Templates	50
	<i>Creating a Gallery</i>	50
	<i>Changing a Gallery's Layout</i>	51
	<i>Assigning Fields to the Parts of a Layout</i>	51
8.2	Creating Galleries from Scratch	52
	<i>Step 1 – Adding a Title</i>	52
	<i>Step 2 – Adding a Gallery</i>	53
	<i>Step 3 – Adding Text Boxes</i>	54
	<i>Step 4 – Adding a Label</i>	55
	<i>Step 5 – Adding a Rectangle</i>	55
	<i>Step 6 – Add Navigation Buttons</i>	56
	<i>Step 7 – Showing the Selected Item</i>	56
8.3	Processing the Selected Item	57
	<i>Creating the Response Screen</i>	57
	<i>The Main Screen and Control Events</i>	58
	<i>Handling Item Selection</i>	58
	<i>Items and Parents</i>	58
	<i>Highlighting the Selected Item</i>	59

9	FILTERING AND SEARCHING	Page
9.1	Tables and Rows	60
	<i>Changing a Gallery's Source Table</i>	60
	<i>The COUNTROWS Function and ALLITEMS Property</i>	61
	<i>Shuffling Rows</i>	61
9.2	Filtering Data	62
9.3	Delegation	63
	<i>The Problem</i>	63
	<i>Some Possible Solutions</i>	63
	<i>Increasing the Delegation Rows Limit (Solution 2)</i>	64
	<i>Importing Static Data (Solution 4)</i>	64
9.4	Searching	65
	<i>Creating a Search Facility using the Search Function</i>	65
	<i>Creating a Search Facility using the Filter Function</i>	66

TABLE OF CONTENTS (3 of 6)

10	VARIABLES	Page
10.1	The Two Main Types of Variable	67
10.2	Working with Global Variables	68
	<i>Our Example</i>	68
	<i>Setting a Global Variable</i>	69
10.3	Sorting using Variables	70
	<i>Initialising Variables on App Start-Up</i>	70
	<i>Running the App Start-up Action</i>	70
	<i>Adding a Sort Icon</i>	70
	<i>Adding Debug</i>	71
	<i>The Sort and SortByColumns Function</i>	71
	<i>Getting the Sorting Working</i>	71
10.4	Context Variables	72
	<i>Our Example</i>	72
	<i>Setting the Values of Context Variables</i>	72
	<i>Passing Context Variable Values between Screens</i>	73
10.5	Viewing Variables	74
	<i>Seeing where Variables are Used</i>	74

11	FORMULAE	Page
11.1	Our Example	75
11.2	Creating Formulae	76
	<i>Expanding the Formula Box</i>	76
	<i>Carriage Returns and Tab Keys</i>	76
	<i>Comments</i>	77
	<i>Indentation (Auto-Formatting)</i>	77
11.3	Testing Conditions (IF and SWITCH)	78
	<i>Testing Single Conditions</i>	78
	<i>Testing Multiple Conditions</i>	78
	<i>The SWITCH Function</i>	79
11.4	Using Conditions in Actions	80
11.5	The Function Wizard	81
11.6	Self and Parent	82
	<i>The Self Operator</i>	82
	<i>The Parent Operator</i>	82

12	IDEAS FOR DYNAMIC APPS	Page
12.1	Introduction	83
	<i>Warning for Developers – Something you Can't Do</i>	83
12.2	Conditionally Enabling Buttons	84
12.3	Relative Positioning on Screen	85
	<i>Using a Variable to Hold the Size of Padding</i>	85
	<i>Positioning the Logo</i>	85
12.4	On-Screen Validation Messages	86
	<i>Using the Match Function to Validate Controls</i>	86
	<i>Setting Validation Properties</i>	87
	<i>Delaying the Validation Response (the DelayOutput Property)</i>	87

13	USING SPECIFIC CONTROLS	Page
13.1	Controls in this Chapter	88
13.2	Rating	88
13.3	Pen Input	89
13.4	Date Picker	90
13.5	Toggle Buttons	90
13.6	Radio Buttons	92
13.7	Check Boxes	92
13.8	Sliders	94
13.9	Text Controls	95

14	CHARTS	Page
14.1	Overview of Charts	96
14.2	Creating a Chart	97
	<i>Connecting to a Data Source</i>	97
	<i>Adding a Chart</i>	97
	<i>The Three Parts of a Chart</i>	98
	<i>Setting the Chart Data</i>	99
	<i>Setting the Chart's Title</i>	99
	<i>Setting the Chart's Legend</i>	100
14.3	Formatting Charts	101
	<i>Formatting Labels</i>	102

TABLE OF CONTENTS (4 of 6)

15	THE TIMER CONTROL	Page
15.1	Our Case Study	103
15.2	Variables Used	104
	<i>Initialising the Variables</i>	104
	<i>Creating Debug for your Variables</i>	104
15.3	Configuring Properties	105
	<i>Starting the Timer when the Form is Used</i>	105
	<i>Creating the Pop-up Message</i>	105
	<i>Displaying the Pop-Up Message</i>	106
	<i>Setting the Text Property of the Timer</i>	106
	<i>The Reset Button</i>	107
15.4	The Main Properties of a Timer	108

16	DROP DOWNS, COMBO BOXES AND LIST BOXES	Page
16.1	Introduction	109
16.2	Drop downs	110
	<i>Setting what Rows a Drop Down Displays</i>	110
	<i>Setting a Blank Top Row</i>	111
	<i>Reacting to a New Choice of Item</i>	111
	<i>Resetting a Drop Down</i>	111
	<i>Formatting Dropdowns</i>	112
16.3	List Boxes	113
16.4	Combo Boxes	114
	<i>Combo Box Data and Layouts</i>	114
	<i>Configuring Search</i>	115
16.5	Cascading Drop Downs	116
	<i>Configuring the Parent Dropdown</i>	116
	<i>Configuring the Child Dropdown</i>	116
	<i>Disabling the Film List Conditionally</i>	117
	<i>An Alternative: Populating the Child Dropdown if No Parent Chosen</i>	117
	<i>The Reset Buttons</i>	118

17	FORMS	Page
17.1	Creating Template Apps using Forms	119
17.2	Creating and Integrating a Details Form	120
	<i>Creating a Gallery</i>	120
	<i>Adding a Details Form</i>	120
	<i>Adding Cards to the Details Form</i>	121
	<i>Adding a Back Button</i>	121
17.3	Working with Cards	122
	<i>The Anatomy of a Card</i>	122
	<i>Unlocking Cards</i>	122
	<i>Custom Cards</i>	123
	<i>Creating New Custom Cards</i>	123
17.4	Edit Forms	124
	<i>Preparing to Edit</i>	124
	<i>Creating an Edit Form</i>	125
	<i>The All-Important Edit Form Mode</i>	126
	<i>Debug: Displaying the Current Mode</i>	126
	<i>The Update Property of a Control</i>	127
	<i>Adding and Editing Items</i>	127
	<i>The Notify Function</i>	129
	<i>Inspecting Success or Failure</i>	129
17.5	Deleting Items	130
	<i>The Removef Command</i>	130
17.6	Adding Controls to Edit Forms	131
	<i>Example: Adding a Toggle Button</i>	131
	<i>Example: Adding a Dropdown</i>	132

18	VALIDATING FORMS	Page
18.1	Avoiding Errors Happening	133
	<i>Changing the Control Type</i>	133
	<i>Changing the Control Formatting</i>	133
	<i>Setting the Maximum Length</i>	134
	<i>Using the IsMatch Function for Email Addresses</i>	134
18.2	Understanding Errors	135
	<i>The Error and ErrorKind Properties</i>	135
	<i>What Happens on Form Submission</i>	135
18.3	Understanding Standard Card Controls	136
	<i>The Star Label to Show Required Fields</i>	136
	<i>The Label to Show Error Messages</i>	136
18.4	Required Fields	137
	<i>Setting a Field to Required</i>	137
	<i>Adding a Simple Error Message</i>	137
	<i>Customising the Default Error Message</i>	137
18.5	More Complex Validation	138

TABLE OF CONTENTS (5 of 6)

19	ADDING, EDITING AND DELETING RECORDS	Page
19.1	Collections	139
	<i>What Collections Are</i>	139
	<i>Creating or Adding to Collections</i>	140
	<i>Clearing Collections</i>	140
	<i>Clearing and Adding to Collections</i>	140
	<i>Viewing Collections</i>	141
	<i>Tables and Collections</i>	141
19.2	The Patch Command	142
	<i>Adding Items using Patch</i>	142
	<i>Editing an Item using Patch</i>	143
19.3	Update and UpdateIf Commands	144
	<i>The Update Command</i>	144
	<i>The UpdateIf Command</i>	145
19.4	Removing Rows	146
	<i>Remove</i>	146
	<i>RemoveIf</i>	146

20	RESPONSIVE APPS	Page
20.1	Responsive Design	147
20.2	Two Problems you'll Encounter	148
	<i>Testing your Changes</i>	148
	<i>Losing Changes</i>	148
20.3	App Settings	149
20.4	Screen Dimensions	150
	<i>The Main Screen Properties</i>	150
	<i>Controlling the Screen Dimensions</i>	150
20.5	Responsive Controls	151
	<i>Setting Parameters</i>	151
	<i>The Important Properties</i>	151
	<i>Case Study: Centring a Title Horizontally</i>	152
	<i>Case Study: Vertical Distances</i>	152
20.6	Responsive Forms	153
	<i>Columns</i>	153
	<i>Snap to Columns</i>	154
	<i>The X and Y Properties for Cards in Forms</i>	154
	<i>The WidthFit Property</i>	155
20.7	Horizontal and Vertical Containers	156
	<i>Our Example</i>	156
	<i>Adding Containers</i>	156
	<i>Our Vertical Container Properties</i>	157
	<i>Our Horizontal Container Properties</i>	158
	<i>Individual Button Properties</i>	158

21	MULTIMEDIA	Page
21.1	Overview of Multimedia Files	159
	<i>Adding and Viewing Multimedia Files</i>	159
	<i>Limits in Power Apps</i>	159
21.2	Audio and Video	160
	<i>Adding Videos</i>	160
	<i>Adding Audio Files</i>	160
	<i>Useful Audio and Video Properties</i>	161
	<i>Audio and Video Actions</i>	161
21.3	Adding Images	162
	<i>Useful Image Properties</i>	162
21.4	The Camera Control	163
	<i>Adding a Camera Control</i>	163
	<i>Listing your Camera Devices</i>	163
	<i>Choosing your Device</i>	164
	<i>Capturing Photos</i>	164
	<i>Storing your Photos in a Database</i>	164
	<i>Streaming</i>	166
21.5	Adding Pictures (File Upload)	167

22	POWER APPS IN POWER BI	Page
22.1	Overview	168
	<i>Sharing Data Sources</i>	168
22.2	Embedding an App	169
	<i>Step 1 - Create a Power BI Report</i>	169
	<i>Step 2 - Adding an App Visual</i>	169
	<i>Step 3 - Creating or Choosing the App to Show</i>	170

23	POWER BI IN POWER APPS	Page
23.1	Overview	171
23.2	Creating the Power BI Report	172
	<i>Setting a Custom Page Size</i>	172
	<i>Publishing the Page</i>	172
23.3	Creating your Dashboard	173
	<i>Pinning a Live Page to a Dashboard</i>	173
	<i>Hiding the Tile's Title and Subtitle</i>	174
23.4	Showing the Live Page in Power Apps	175

TABLE OF CONTENTS (6 of 6)

24	COMPONENTS	Page
24.1	What are Components?	176
24.2	Simple Components	177
	<i>Creating Components</i>	177
	<i>Populating Components</i>	177
	<i>Adding Components to a Screen</i>	178
24.3	Overview of Custom Properties	179
	<i>About Custom Properties</i>	179
	<i>Types of Custom Property</i>	179
24.4	Case Study: Input Property	180
	<i>Creating a Custom Property</i>	180
	<i>Using Custom Property Values</i>	181
	<i>Assigning Values to our Input Property</i>	181
24.5	Case Study: Output Property	182
	<i>Step 1 - Adding the Dropdown</i>	182
	<i>Step 2 – Adding the Custom Property</i>	183
	<i>Step 3 - Linking the Custom Property to the Colour Dropdown</i>	183
	<i>Step 4 - Setting the Component's Fill Colour</i>	184
	<i>Step 5 – Setting each Screen's Fill Colour</i>	184

25	POWER AUTOMATE	Page
25.1	Overview	185
	<i>Power Automate flows</i>	185
25.2	Case Study: Sending Output Back to Power Apps	186
	<i>Step 1 – Creating the Power App</i>	186
	<i>Step 2 – Create the Flow</i>	186
	<i>Step 3 – Renaming your Flow</i>	187
	<i>Step 4 – Adding a Step</i>	187
	<i>Step 5 – Configuring the Step</i>	187
	<i>Step 6 – Testing your Flow</i>	188
	<i>Step 7 – Using the Flow Output</i>	189

CHAPTER 1 - POWER APPS OVERVIEW

1.1 Types of App

When you're creating apps in Power Apps, you have a choice of 3 types, as shown on the right:

Most people will choose a **Canvas** app.

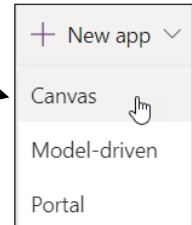

These are used as follows:

Type of app	Notes
<i>Canvas</i>	With a canvas app you start from a blank screen, can link to any types of data source and have free rein to get your app to do whatever you want.
<i>Model-driven</i>	A model-driven app must be based on a Common Data Services model, usually Dynamics 365. You're much more restricted in what you can do, and many of the forms are created for you based on the structure of the model to which you're connecting.
<i>Portal</i>	A portal app must also be based on a Common Data Services model. Portal apps are the newest of the three types, and allow you to create apps for external users.

This courseware will focus exclusively on canvas apps.

Examples of Apps

Here are two simple apps you could create using Power Apps:

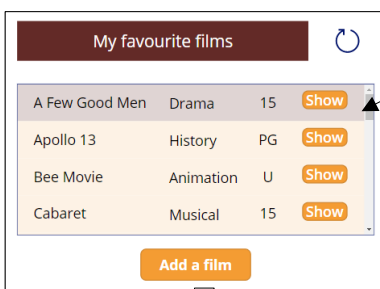

This app lets you list out your favourite films, change their details and even add new films. The films could be stored in a cloud-based Excel workbook, a SQL Server database linked by a gateway, a SharePoint list or any other data source accessible from the cloud.

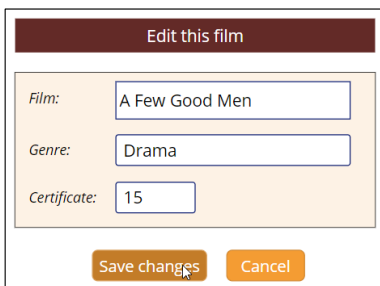

This very simple app uses a five-star rating control, one of many such gizmos that make Power Apps apps such a pleasure to design and use. Clicking on the button takes you to a second screen giving your vote:

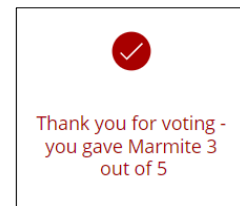

1.2 What you Need

To Design your Apps

You can run Power Apps either through a modern browser like Edge or Chrome, or else through a desktop program called Power Apps:

The desktop version of Power Apps will be deprecated soon. You don't need to bother downloading it; instead just go to:
<https://powerapps.microsoft.com/>

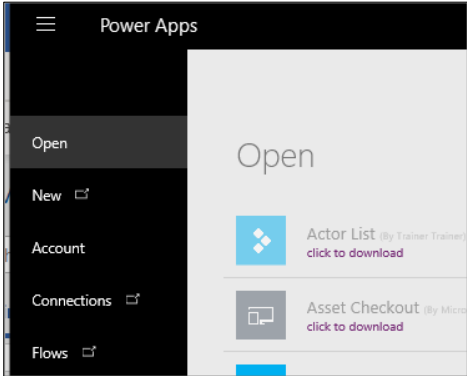

To Run your Apps

You can run your apps in any modern browser, and also on your Android or Apple phone:

- a) Download the **Power Apps** app from the Google or Apple store.
- b) You can run any app by scrolling up or down the list to find it, then tapping on it.

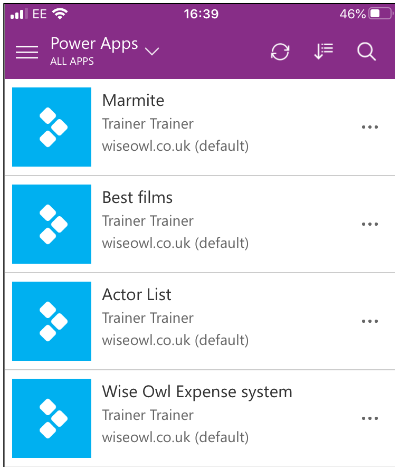

1.3 Getting Help

Here are the sources which Wise Owl found useful when learning Power Apps.

The Microsoft Website

Yes, really! Microsoft have put a lot of effort into providing tutorials on using Power Apps (the one on edit forms is especially good):

a) Click on this tab on the left-hand side of the Power Apps home page.

b) Click on this button to bring up the main help page.

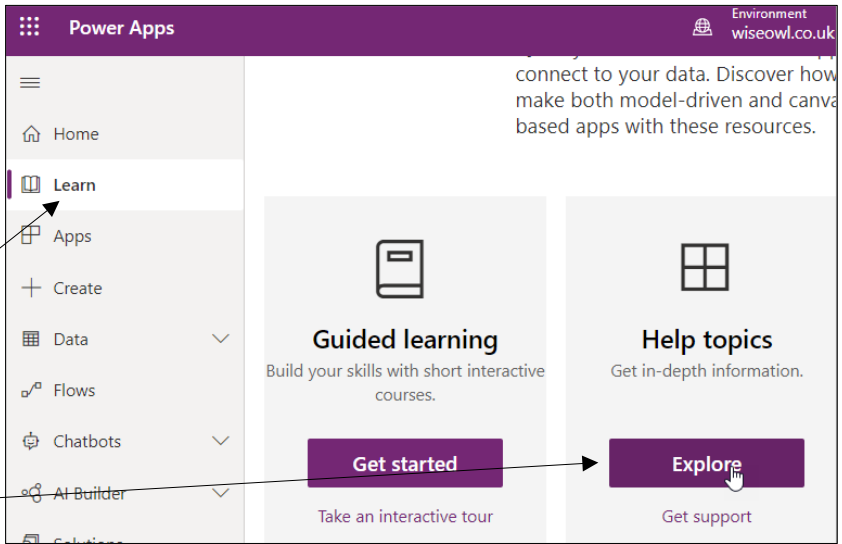



Opening Template Apps

There are a number of sophisticated pre-built apps that you can open and inspect:

a) Click on this button on the left side of the Power Apps home page, and choose to create an app.

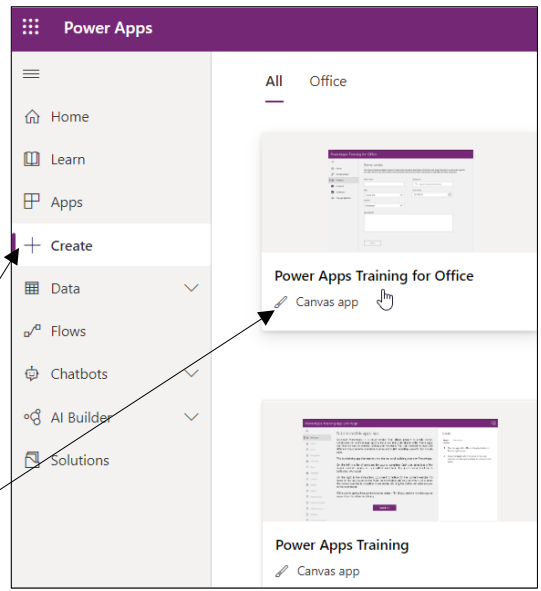
b) Scroll down to see the apps already created for you to use, and choose one you like the look of!





And finally, an honourable mention to Shane Young. There are many tutorials on Power Apps online, but Shane's were the ones we found most useful (plus he's engaging company, even if you will learn more about his dog than you want to!).

CHAPTER 2 - CREATING

2.1 Our Simple Starter App

This chapter (and the next two) will show you how to create the following app:

When you choose a rating and click on the voting button, the app tells you what you voted. Note that for this simple app nothing is saved!

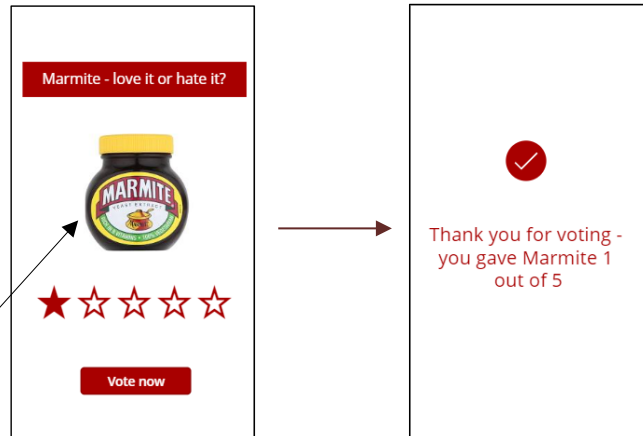

This app contains two *screens*:

Screen	Name we'll use	Notes
	scrVoteForm	This is the voting screen, where we record whether we like Marmite (the author doesn't).
	scrResults	This is the results screen, reflecting back our preferences.



Note that we'll (mostly) use Modified Hungarian Notation to name things in our app (a fancy way of saying that the first 3 letters of the thing's name denote what sort of a thing it is – so **scr** for **S**creen, for example).

2.2 Working with Apps

Creating Apps

Assuming that you're in Power Apps, here's how to create a new app from the home screen.



Wise Owl's Hint

You can also create an app using the **New app** button from the **Apps** menu. This gives menu options which do the same thing, albeit formatted differently for some reason.

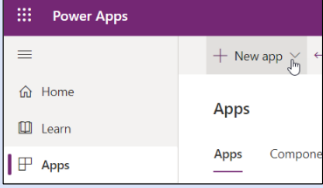

Choose to create an app:

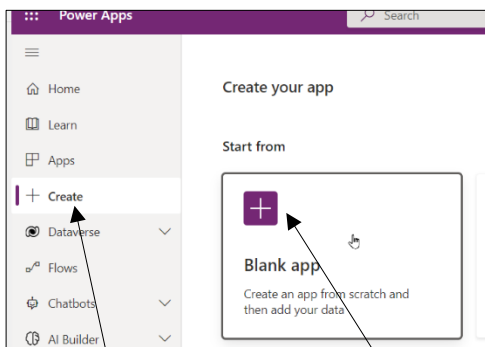

a) Choose this menu option.

b) Choose to create a new blank app.

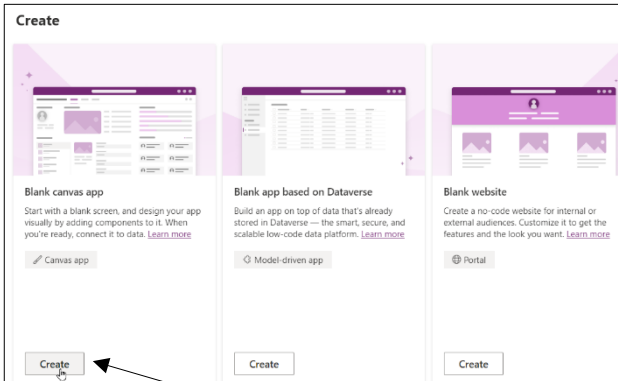

c) Choose to create a canvas app (you can also see a good description of model-driven and portal apps here).

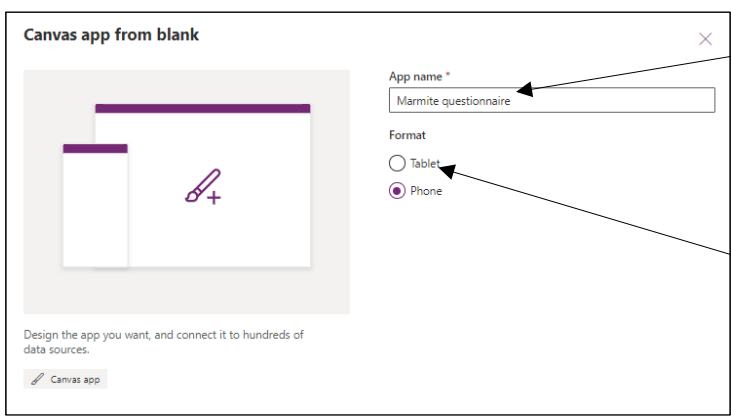

d) Give your new app a name (we've called this one **Marmite questionnaire**).

e) Decide whether to create a tablet or phone app (note that you can't change this later). If you're not sure, it's probably better to create a tablet app, since Power Apps will usually do a good job of shrinking a tablet app to display sensibly on a phone. Many people create two different versions of their apps (one for viewing on a tablet and one for viewing on a phone).



Wise Owl's Hint

For some reason Power Apps is more inclined to add search boxes at the top of screens when you create a mobile app using a template, as opposed to creating a tablet app using a template. Most of the examples in this courseware use mobile apps.

If you're successful, you can now see your app!

Presumably the fact that you're reading this courseware means you can skip the tutorial offered

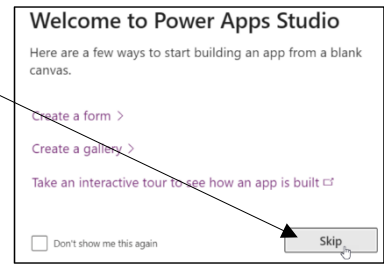

Saving your Apps

It's a good idea to save your app as soon as you've created it:

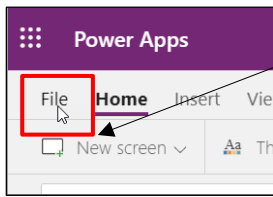

a) Choose to go to the File menu.

b) Choose to save the file with a new name.

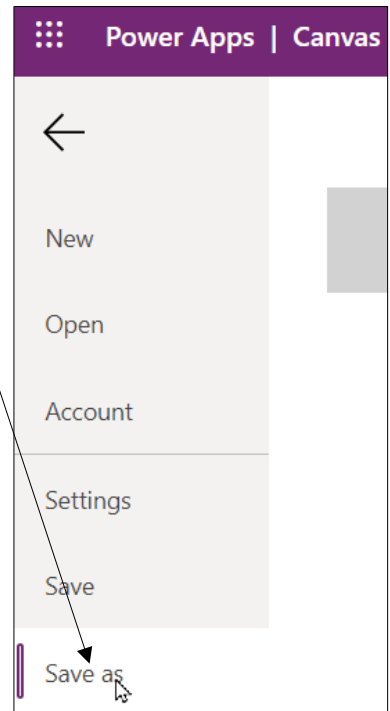

c) Choose where you want to save your file (your local computer, or your cloud account).

d) Give your new app a sensible name.



e) If you choose to save your file to Power Apps in the cloud (as you usually will), this dialog box will appear. Don't worry for now about why you might have different versions of your app!



Auto-save will prevent you losing much work if you close down your app without saving your changes, but be warned that this only kicks in once you've saved your file to start with.

Opening Apps

Once you've created one or more apps, here's how to open each:

Click on the app you want to edit, then choose one of the two options shown boxed. If you click on the name of the app, this won't work (it will play the app, rather than allowing you to edit it).

You may then have to skip the tutorial showing how to work with apps (depending on whether you've ticked the box to ask not to see this question again).

Welcome to Power Apps Studio
Here are a few ways to get started if this is your first time editing an app.
[See a preview of this app >](#)
 Don't show me this again

Wise Owl's Hint

Important note: you can only edit one app at a time in Power Apps.

Closing Apps

To close an app, just close its browser page:

When you click on the cross on a browser tab to close the tab ...

Leave site?
Changes you made may not be saved.

... Power Apps will warn you if you have unsaved changes.

2.3 App Settings

When you create an app, you can give it a name and an icon, and choose whether you want to view it in portrait or landscape mode (among other useful settings):

Begin by choosing the **File** menu, then choose **Settings** from the menu which appears on the left of your screen.

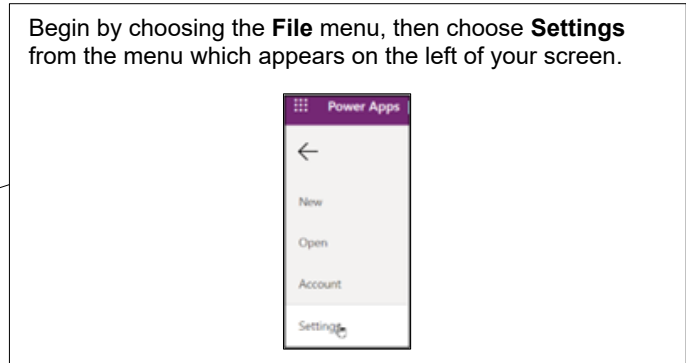
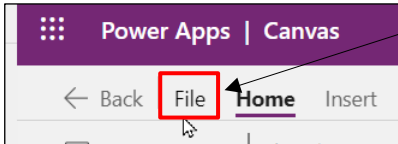

Changing the Name and Icon

Here's how to change the name of your app, and assign an icon to it:

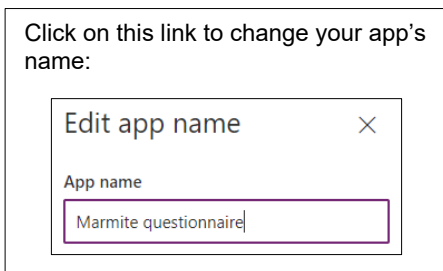

Choose an icon from the list (you can also browse to your own, as we've done here).

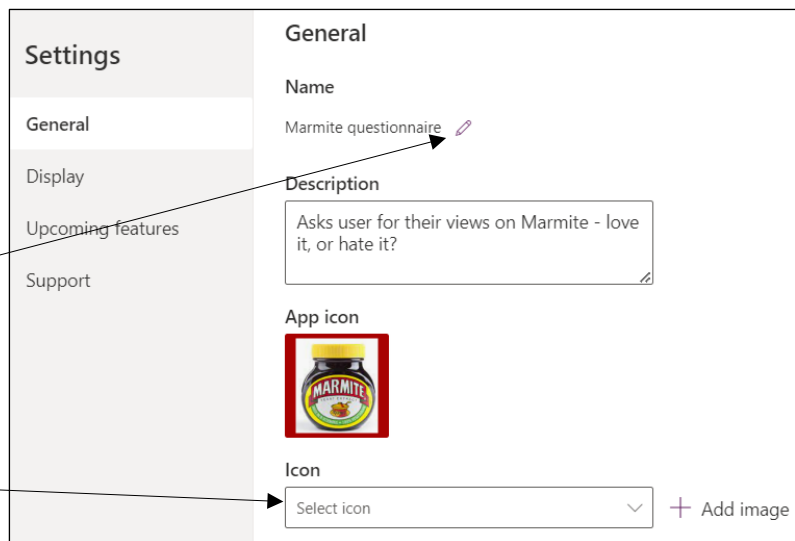

Setting Screen Size (Tablet Apps Only)

If you're building a tablet app, you can say how big your target screen is:

a) Choose to show the **Display** settings from the **File → Settings** dialog box.

b) Say what size of screen you're aiming for (you should also consider the settings shown on the next page at this point).

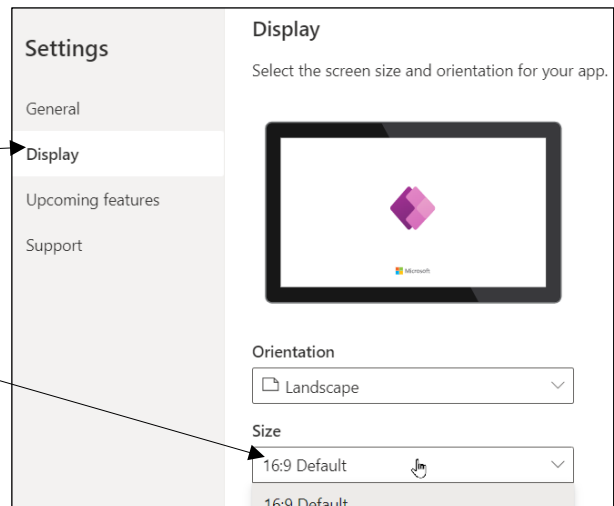
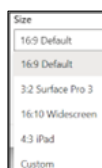

Changing and Locking Orientation

Apps are much easier to design if you can fix their view to either landscape or portrait:

b) Choose whether to view it in portrait or landscape mode.

c) Suppose you are designing a phone app, and a user runs it on their large laptop screen. What should happen? If you have **Scale to fit** turned **On** (as here), Power Apps will increase the size of all of your controls to fill the screen, which will probably look strange; if you have it turned off, Power Apps will use responsive layout to redraw controls on the screen according to its size. This will give better results, but will mean that you have to consider responsive screen layout throughout your app design.

d) Locking your screen aspect ratio makes designing apps easier, but means your apps may look strange on (for example) square screens.

e) Locking the orientation means that when a user rotates their phone, your app won't change. If you turn this option on, you'll need to confirm it:

Lock orientation

Locking the orientation may reduce the accessibility of your app for some users.

Cancel

Continue

a) Choose to change the display settings for your app.

Settings

General

Display

Upcoming features

Display

Orientation

Landscape

Size

16:9 Default

Scale to fit

Scales the app to fit available space. Turning this off allows screens and controls to fill the available space.

On

Lock aspect ratio

Locking this automatically maintains the ratio between height and width to prevent distortion.

On

Lock orientation

Locking orientation keeps the screen in its current orientation, even when the device is rotated.

On



For an easy life, turn all of the options on (as shown above). To design a professional app, you should probably turn all 3 options off and build responsive design into every screen of your app (no small undertaking), as described in a separate chapter later in this courseware.

2.4 The Power Apps Screen

Here's how the Power Apps screen looks:

Click on this icon to hide or display the left-hand menu bar.

The Power Apps menu (here we're looking at the **Home** tab).

Tree view allows you to see each screen and its constituent parts.

The **formula bar** shows the value of current properties.

You can click on this icon to fit the contents of the current screen within its window again, or use the slider to zoom in or out.

The **Properties** window allows you to see – and change – the properties of screens and controls.

Adding (and Moving) Screens

To add a screen:

- a) Choose to insert a new screen (regardless of what you currently have selected, Power Apps will insert the new screen at the end of the current list of screens).

- b) Choose what sort of screen you want (for our app we used **Blank** for the first screen and **Success** for the second).

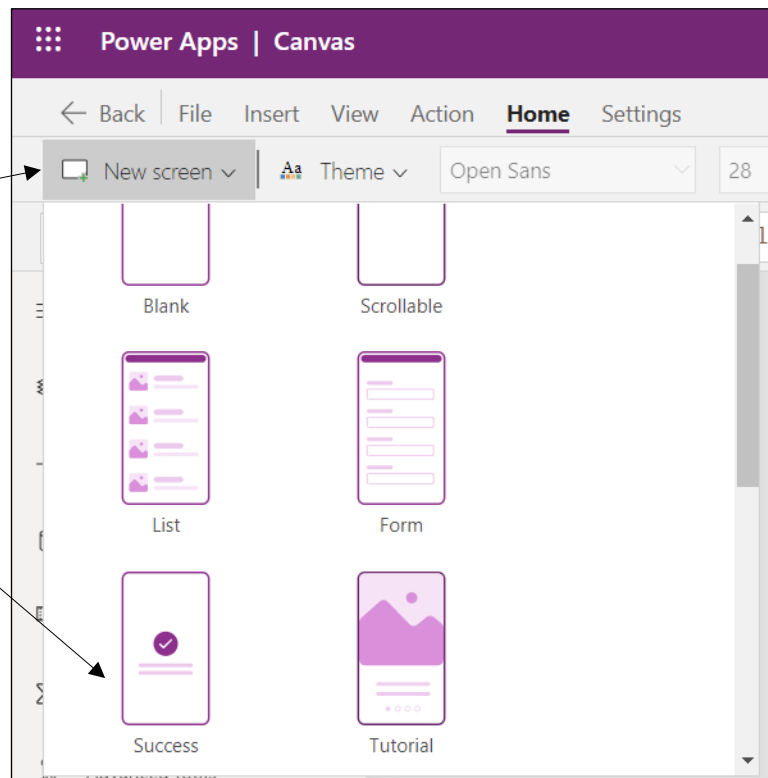







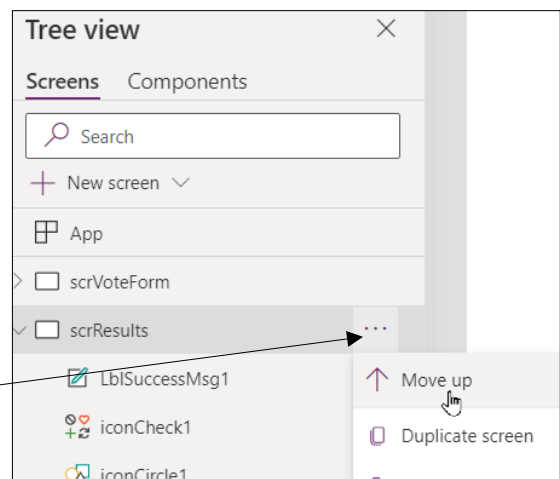

























Moving Screens

Remarkably, you can't drag and drop screens to change their order, so instead use this menu:

Click on the symbol and choose to move a screen up (or down) the list.



What we do!

		Basic training	Advanced training	Systems / consultancy
Office	Microsoft Excel			
	VBA macros			
	Office Scripts			
	Microsoft Access			
Power BI, etc	Power BI and DAX			
	Power Apps			
	Power Automate (both)			
SQL Server	SQL			
	Reporting Services			
	Report Builder			
	Integration Services			
	Analysis Services			
Coding	Visual C#			
	VB programming			
	MySQL			
	Python	